

DIESEL GENSET - 50 HZ

WATER CHARGE-AIR COOLING

2145 - 2285 kVA
400V

BENEFITS

- // Low installment cost
- // Best fuel consumption values
- // Long maintenance intervals
- // High-efficiency components
- // Best-in-class reliability and availability



SYSTEM RATINGS

Prime Power

Genset Type	Engine Type	Nominal Rating kVA	Emissions
DP 2145 D5S	16V 4000 G23	2145	Fuel optimized, TA-Luft
DP 2285 D5S	16V 4000 G63	2285	Fuel optimized, TA-Luft

// REFERENCE CONDITIONS

Ambient air temp.:	25°C (77°F)
Charge air coolant temp.:	55°C (131°F)
Ambient air pressure:	1000 mbar
Altitude above sea level:	100 m

// ENGINE DATA

Bore/Stroke	170/210 mm (6.7/8.3 in)
Cyl. configuration	90°V
Cyl. displacement	4.77 lit. (291 cu in)
Displacement, total	16V: 76.3 lit. (4655 cu in)
Fuel specification	EN 590, Grade No.1-D/2-D (ASTM D975-00)

Application	Definition
3B	Prime Power Continuous operation with variable load Load factor: < 75 % Operating hours/year: unrestricted Overload: 10 % capability (ICXN)

All Gensets are available with optional voltages 380V and 415V. Ratings can variate please contact your MTU distributor.
 Rated Power available up to 40°C/400m and Charge- air coolant temperature for fuel optimized: 70°C or for TA-Luft: 55°C

	Fuel Optimized		TA-Luft	
	Prime Power			
Genset Type	DP2145D5S	DP2285D5S	DP2145D5S	DP2285DS
Engine Type	16V 4000 G23	16V 4000 G63	16V 4000 G23	16V 4000 G63
Generator type	744RSL7056	744RSL7056	744RSL7056	744RSL7056
Fuel Consumption *				
100% load	g/kWh (l/h)	192 (416)	191 (452)	219 (474)
75% load	g/kWh (l/h)	195 (317)	193 (343)	214 (348)
50% load	g/kWh (l/h)	205 (222)	203 (240)	217 (235)
Electrical Radiator**				
Max. air temp. on fan	°C	45	45	45
Ambient temperature	°C	40	40	40
Fan air flow	m ³ /s	29.43	31.14	47.23
Air flow restriction	Pascal	200	200	200
Air Intake				
Intake air depression	mbar	15	15	15
Intake air flow	m ³ /s	2.1	2.3	3.2
Exhaust System				
Exhaust gas flow	m ³ /s	5.4	5.8	7.4
Exhaust gas temperature	°C	480	485	480
Exhaust back pressure	mbar	30	30	30
Generator				
Temperature rise (Insulation Class H)	°C	125	125	125
Lube System				
Engine oil capacity	l (gal)	300 (79)	300 (79)	300 (79)
Emissions				
NOx	mg/Nm ³	-	-	1700
CO	mg/Nm ³	-	-	300
Dust	mg/Nm ³	-	-	50
Air born noise level at 1m	dB(A)	107	109	108
Exhaust noise level at 1 m	dB(A)	112	113	113
Genset				
Lengths	mm (in)	5090 (200)	5090 (200)	5090 (200)
Widths	mm (in)	1690 (67)	1690 (67)	1690 (67)
Height	mm (in)	2150 (85)	2150 (85)	2150 (85)
Total Weight, wet	kg (lbs)	14169 (31237)	14179 (31259)	14881 (32807)
Genset convection heat incl. 10m exhaust pipes	kW (bhp)	180 (241)	197 (264)	180 (241)

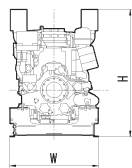
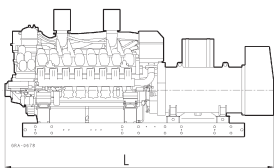

* Values referenced are in accordance with ISO 3046-1. Conversion calculated with fuel density of 0.83 g/ml.
 ** Optional scope: Radiator with electrical fan drive for front or remote installation. Connection parts for front installation available as option.

Note: This drawing is provided for reference only and should not be used for planning installation. Please contact your local distributor for more detailed information. Materials and specifications subject to change without notice.