

DIESEL GENSET - 50 HZ

WATER CHARGE-AIR COOLING

2870 - 3310 kVA
400V

BENEFITS

- // Low installment cost
- // Best fuel consumption values
- // Long maintenance intervals
- // High-efficiency components
- // Best-in-class reliability and availability



SYSTEM RATINGS

Standby Power

Genset Type	Engine Type	Nominal Rating kVA	Emissions
DS 2870 D5S	20V 4000 G23	2870	Fuel optimized
DS 3170 D5S	20V 4000 G63	3170	Fuel optimized
DS 3310 D5S	20V 4000 G63L	3310	Fuel optimized

// REFERENCE CONDITIONS

Ambient air temp.:	25°C (77°F)
Charge air coolant temp.:	55°C (131°F)
Ambient air pressure:	1000 mbar
Altitude above sea level:	100 m

// ENGINE DATA

Bore/Stroke	170/210 mm (6.7/8.3 in)
Cyl. configuration	90°V
Cyl. displacement	4.77 lit. (291 cu in)
Displacement, total	20V: 95.4 lit. (5822 cu in)
Fuel specification	EN 590, Grade No.1-D/2-D (ASTM D975-00)

Application	Definition
3D	Standby Power Standby operation with variable load Load factor: < 85 % Operating hours/year: max. 500 Overload: Fuel stop power (IFN)

All Gensets are available with optional voltages 380V and 415V. Ratings can vary please contact your MTU distributor.
Rated Power available up to 40°C/400m and Charge- air coolant temperature 70°C

		Fuel Optimized		
		Standby Power		
Genset Type		DS2870D5S	DS3170D5S	DS3310D5S
Engine Type		20V 4000 G23	20V 4000 G63	20V 4000 G63L
Generator type		1030FDL7005	1030FDL7008	1030FDL7005
Fuel Consumption *				
100% load	g/kWh (l/h)	193 (563)	192 (618)	193 (663)
75% load	g/kWh (l/h)	199 (435)	196 (473)	195 (502)
50% load	g/kWh (l/h)	210 (306)	206 (331)	205 (352)
Electrical Radiator**				
Max. air temp. on fan	°C	45	45	45
Ambient temperature	°C	40	40	40
Fan air flow	m ³ /s	35.51	41.49	53.98
Air flow restriction	Pascal	200	200	200
Air Intake				
Intake air depression	mbar	15	15	15
Intake air flow	m ³ /s	2.7	3.0	3.2
Exhaust System				
Exhaust gas flow	m ³ /s	7.3	8.0	8.5
Exhaust gas temperature	°C	500	505	500
Exhaust back pressure	mbar	30	30	30
Generator				
Temperature rise (Insulation Class H)	°C	125	125	125
Lube System				
Engine oil capacity	l (gal)	390 (103)	390 (103)	390 (103)
Emissions				
NOx	mg/Nm ³	-	-	-
CO	mg/Nm ³	-	-	-
Dust	mg/Nm ³	-	-	-
Air born noise level at 1m	dB(A)	106	107	108
Exhaust noise level at 1 m	dB(A)	118	117	118
Genset				
Lengths	mm (in)	6320 (249)	6320 (249)	6320 (249)
Widths	mm (in)	1840 (72)	1840 (72)	1840 (72)
Height	mm (in)	2730 (107)	2730 (107)	2730 (107)
Total Weight, wet	kg (lbs)	14905 (32860)	16583 (36559)	16583 (36559)
Genset convection heat incl. 10m exhaust pipes	kW (bhp)	242 (325)	267 (358)	385 (382)

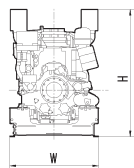
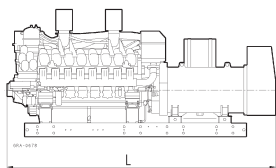

* Values referenced are in accordance with ISO 3046-1. Conversion calculated with fuel density of 0.83 g/ml.
 ** Optional scope: Radiator with electrical fan drive for front or remote installation. Connection parts for front installation available as option.

Note: This drawing is provided for reference only and should not be used for planning installation. Please contact your local distributor for more detailed information. Materials and specifications subject to change without notice.